

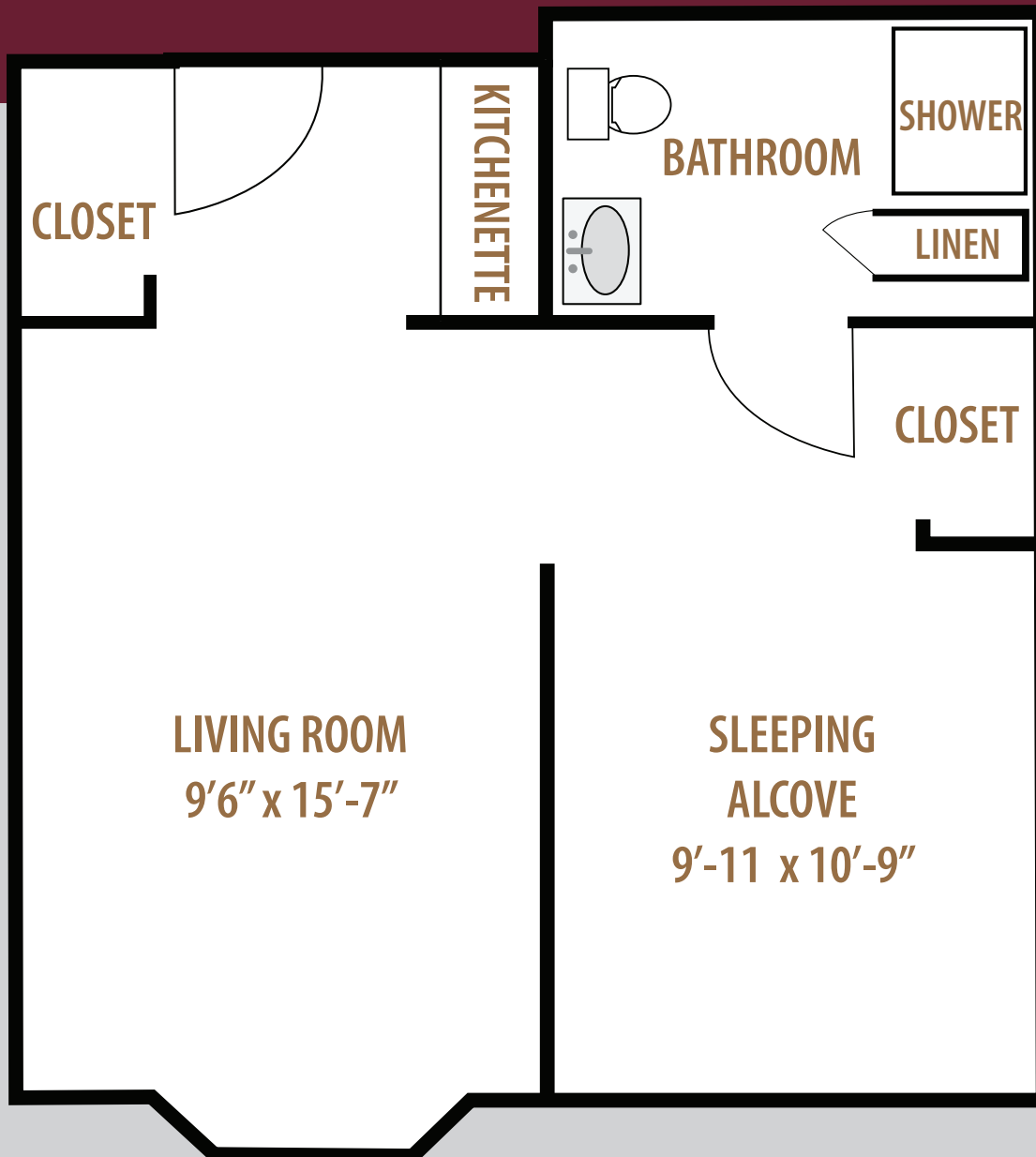

**NORTHPOINTE WOODS**  
A SENIOR LIVING COMMUNITY

INDEPENDENT LIVING | **ASSISTED LIVING** | MEMORY CARE



## Sleeping Alcove - One Bath

Floor plan subject to change. Diagrammatic representation may not indicate actual dimensions.

For more information, please call 269.964.7625



Find us on 